

Appendix A

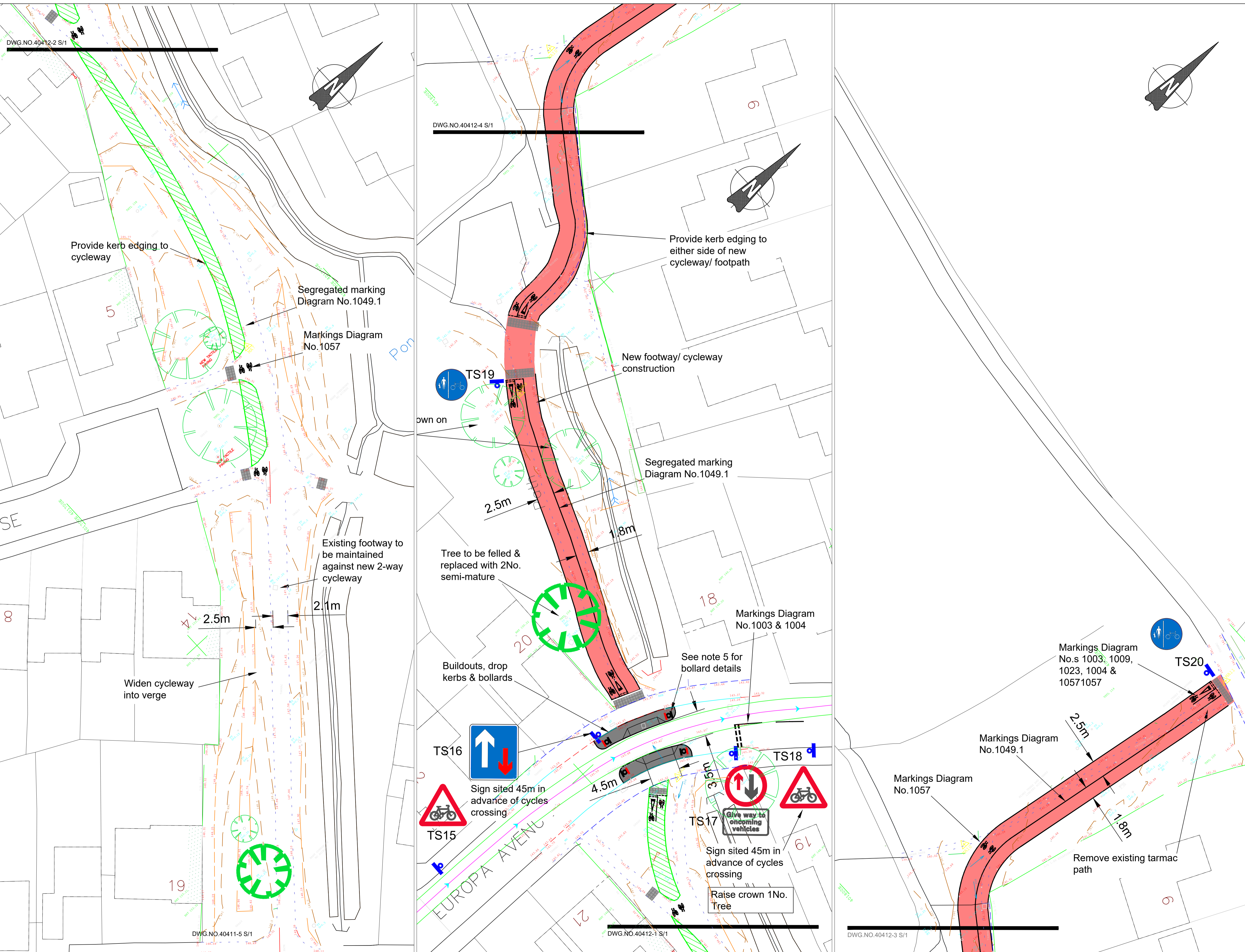

© Crown copyright and database rights 2012
Ordnance Survey Licence No 100032119

IMPORTANT
The Contractor will be responsible for setting out the work. All dimensions must be obtained from or checked on site. Figured dimensions to be used in preference to scale.

- NOTES**
- All signs and road markings to be in accordance with The Traffic Signs Regulations and General Directions 2016 (TSRGD) and Chapter 5 Road Markings 2018.
 - For sign arrangement refer to SMBC standard detail drawing SD/1200/03 R.1.
 - All service chambers and street furniture within proposed cycleway/buildouts to be relocated to suitable location.
 - Refer to "Appendix 3 - Guide to the Design of New Streets" for new carriageway widths.
 - For bollard details, refer to SMBC standard detail, drawing number SD/2700/03 with reflective contrast bands to determine priority.
 - Statutory Undertakers searches/ checked prior to any excavations.

KEY

TS01 Proposed Sign and reference number

Footway construction (Off carriageway) - Area=595m²

Footway widening (Off carriageway) - Area=236m²

Corduroy (ladder) paving

FOOTWAY (WIDENING) CONSTRUCTION SPECIFICATION

All materials are to be supplied and laid in accordance with BS EN 13108. Granite aggregate only, Appendix 3 - Guide to the design of new streets.

SURFACE COURSE
20mm (6mm) Nominal size

BINDER COURSE
50mm (20mm) Nominal size

SUB BASE
150mm Type 1 Stone (MCHW clause 8)



HIGHWAYS GROUP MANAGER
Robin Weare, BSc, C.Eng, M.I.C.E, MBA
Sandwell Council House
Freeton Street Oldbury
West Midlands B69 3DE
E-mail: Highways@sandwell.gov.uk

PROJECT
Town Funds Improvements
Europa Avenue/WB TC - Sheet 7

LOCATION
WEST BROMWICH

DRAWING TITLE
General Arrangement

SCALE	1:250m
ISSUED BY	Service Manager, Highways
DATE	December 2020
DRAWN BY	JF
DRAWING No	40412 S/1